

Parcels Buffer

Assessor PIN: 412400400000
Owner Name 1: MCHUGH, JULIE A.
Legal Desc. 1: PT NW COR N 1/2 NE
Legal Desc. 2: 180.00' X 163.68'
Deed: V 236P1993

More Results Available

600 First St.

SCANNED
Save in case they
decide to go to
BZA. 5-9-11

Zoom to this feature

Assessor PIN: 412400380000
Owner Name 1: FRUCHEY, LYNN B., TRUSTEE
Legal Desc. 1: PT NW COR N 1/2 NE
Legal Desc. 2: 225.89' X 163.68'
Deed: V 171P1736

623 Second St.

233 W. Barnes

Zoom to this feature

Assessor PIN: 410092210440
Owner Name 1: FANNIE MAE
Legal Desc. 1: LOT 22 O E HUDDLE'S SUB
Legal Desc. 2: DIV
Deed: V 257P 937

One South Wacker Drive
Suite 3100
Chicago IL 60606

Zoom to this feature

Assessor PIN: 410092210460
Owner Name 1: HARMON, TERRY J.
Legal Desc. 1: LOT 23 O E HUDDLE'S SUB
Legal Desc. 2: DIV
Deed: V 242P2354

214 Pontious PL

Zoom to this feature

Assessor PIN: 410092210480
Owner Name 1: BROWNING, ANNABELLE
Legal Desc. 1: LOT 24 O E HUDDLE'S SUB
Legal Desc. 2: DIV
Deed: V 128P 621

212 Pontious PL

Zoom to this feature

Assessor PIN: 410090310020
Owner Name 1: REBEAU, GREGORY E., ETAL
Legal Desc. 1: LOT 1 E T BARNES 1ST-OL
Deed: V 242P 826

11-583 Co. Rd. 03

Zoom to this feature

Assessor PIN: 410090310040
Owner Name 1: RITTER, JOHN L., ETUX
Legal Desc. 1: LOT 2 E T BARNES 1ST-OL
Deed: V 236P 476

165 W. Maumee

Zoom to this feature

Assessor PIN: 410090310080
Owner Name 1: OTTO, DONNA J.
Legal Desc. 1: LOT 3 E T BARNES 1ST-OL
Legal Desc. 2: EX S 85'
Deed: V 232P 106

157 W. Maumee

Zoom to this feature

Assessor PIN: 410090310060
Owner Name 1: CLINE, JOSEPH A ETUX
Legal Desc. 1: LOT 3 E T BARNES 1ST-OL
Legal Desc. 2: S 85'
Deed: V 254P1974

224 W. Barnes

Zoom to this feature

Assessor PIN: 410090310100
Owner Name 1: ARPS, RYAN D.
Legal Desc. 1: LOT 4 E T BARNES 1ST-OL
Deed: V 181P2208

15-762 Co. Rd. M1

Zoom to this feature

Assessor PIN: 410090310120

Owner Name 1: WILSON, LULU IONE, ETVIR
Legal Desc. 1: LOT 5 E T BARNES 1ST-OL
Deed: V 232P2491

206 W. Barnes

Zoom to this feature

Assessor PIN: 410090311140
Owner Name 1: BUCHHOLZ, BRANDON T.
Legal Desc. 1: LOT 49 E T BARNES 1ST-OL
Deed: V 247P1380

313 W. Barnes

Zoom to this feature

Assessor PIN: 410090311121
Owner Name 1: SCHIPLE, ALVA LEE, ETUX
Legal Desc. 1: LOT 48 ET BARNES 1ST OL
Legal Desc. 2: EX S 70'
Deed: V 235P 461

303 W. Barnes

Zoom to this feature

Assessor PIN: 410090311120
Owner Name 1: KEDOCIA, ALAN E.
Legal Desc. 1: LOT 48 E T BARNES 1ST-OL
Legal Desc. 2: S 70'
Deed: V 13P 932

609 First

Zoom to this feature

Assessor PIN: 412400440000
Owner Name 1: MENGERINK, JAMES A., ETUX (LE)
Legal Desc. 1: PT NW COR N 1/2 NE
Legal Desc. 2: (W 72.5'X163.68')
Deed: V 23P 701

328 Oak St.

Zoom to this feature
Next Page

Parcels Buffer

Assessor PIN: 412495610020
Owner Name 1: EVERS, TABB L., ETAL
Legal Desc. 1: LOT 1 STEWARD ADDN
Legal Desc. 2: 73.19' X 98.38'
Deed: V 261P 827

14-092 Co Rd U

Zoom to this feature

Assessor PIN: 412495610040
Owner Name 1: MILLER, GEROLD, ETUX
Legal Desc. 1: LOT 2 STEWARD ADDN
Legal Desc. 2: 90.57' X 98.38'
Deed: V 239P 797

330 Oak

Zoom to this feature

Assessor PIN: 410090311080
Owner Name 1: HOME SOLUTIONS I
Legal Desc. 1: LOT 47 E T BARNES 1ST-OL
Deed: V 243P2319

Rodney Gill
233 W. Barnes

Zoom to this feature

Assessor PIN: 410090311060
Owner Name 1: WESTHOVEN, LINDSAY P., ETUX
Legal Desc. 1: LOT 46 E T BARNES 1ST-OL
Deed: V 212P 296

8927 Co Rd P3

Zoom to this feature

Assessor PIN: 410090311040
Owner Name 1: GARCIA, RAMIRO, ETUX
Legal Desc. 1: LOT 45 E T BARNES 1ST-OL
Deed: V 89P 850

213 W. Barnes

Zoom to this feature

Assessor PIN: 410090311020
Owner Name 1: BAERLIN, MARY
Legal Desc. 1: LOT 44 E T BARNES 1ST-OL
Deed: V 252P 540

205 W. Barnes

Zoom to this feature

End of Result Set

[Previous Page](#)

Henry County Ohio

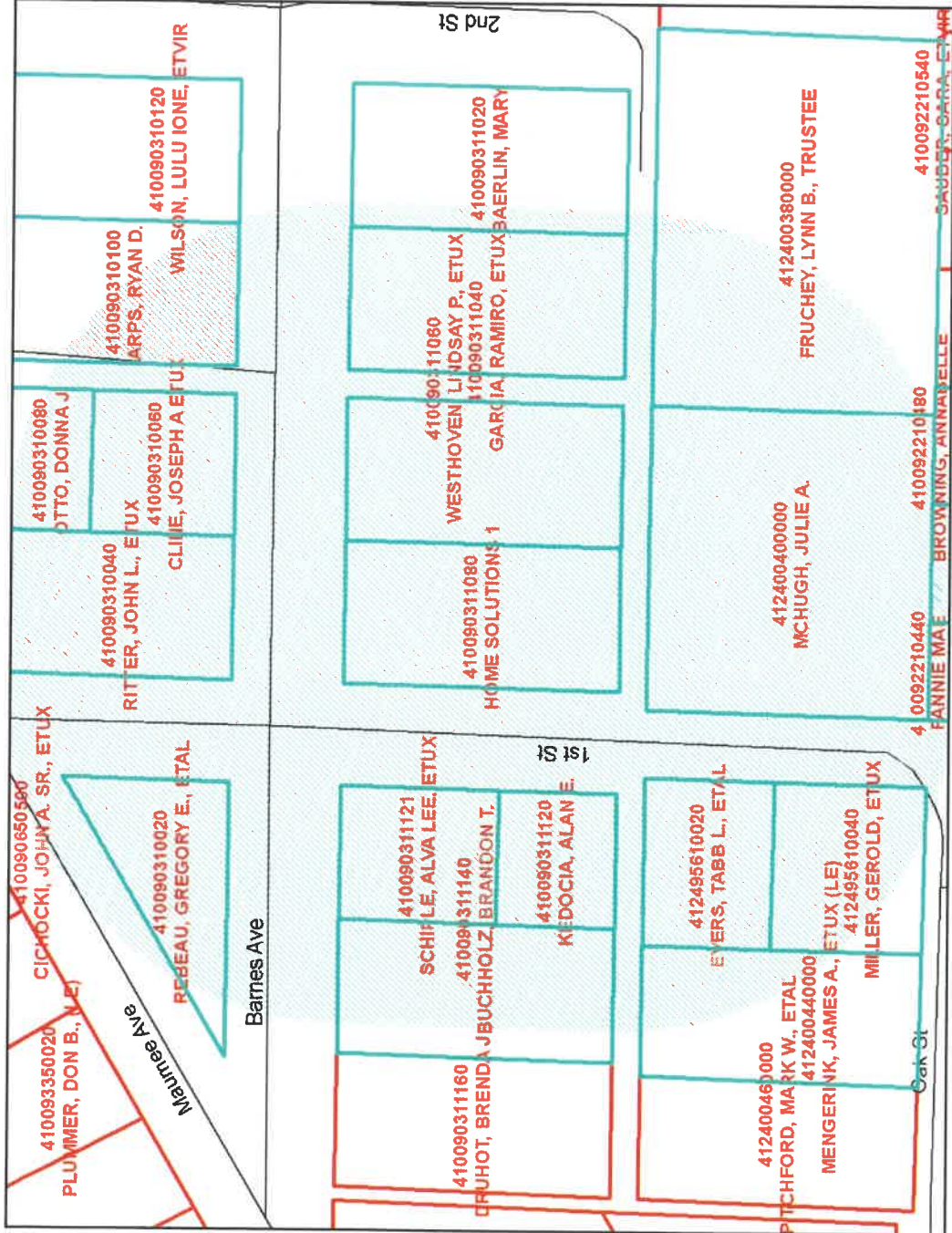

This map is a user generated static output from an Internet mapping site and is for general reference only. Data layers that appear on this map may or may not be accurate, current, or otherwise reliable. THIS MAP IS NOT TO BE USED FOR NAVIGATION.

Map center: 1523039, 629862



Auditor - Kevin Nye

Legend

Administrative

- County
- Cities

Parcels

- Parcels

Transportation

- State Highways
- US Highways

Water

- River



Scale: 1:1,187